

Clare School

Community centre

Evangelie Trail

potential gathering area

potential gathering area

Proposed concrete pedestal and lighting for cupola

plant bed - typ.

sidewalk

painting pavement games

infant play area

57 sq.m.

Area 57 sq m (613 sq ft) Play Structure: Cube

5-12 play area

145 sq.m.

Area: 150 sq m (1614 sq ft) Play Structure: Venti

septic field open grass area

picnic tables

multi-hoop

decorative fence

chain link fence

basketball court

NORTH ARROW:

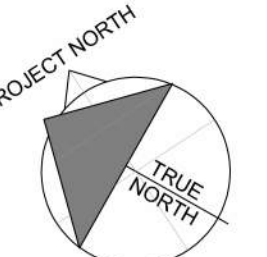

Scale: 1:500

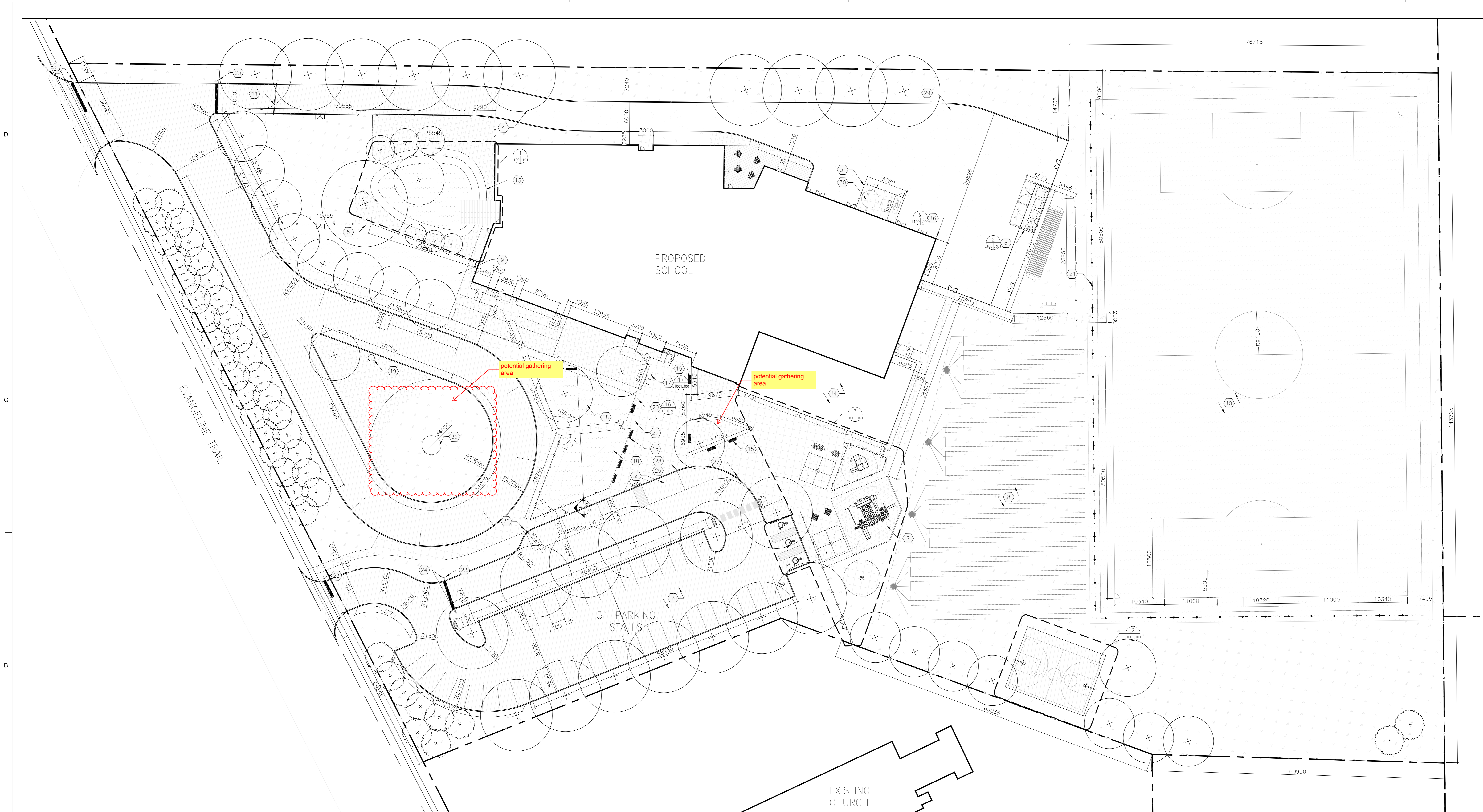

- KEYNOTES:**
- BUS DROP-OFF LOOP
 - STUDENT DROP-OFF LOOP
 - ASPHALT PARKING LOT - STAFF/VISITOR PARKING - 51 STALLS
 - UTILITY ACCESS LANE
 - 1.2m HT FENCE
 - GARBAGE/RECYCLING BINS
 - 5-12 YEAR-OLD PLAYGROUND
 - SEPTIC FIELD / MULTI-USE FIELD
 - PRE-PRIMARY PLAYGROUND
 - 67m x 107m SOCCER FIELD
 - MAINTENANCE/VEHICULAR GATE
 - PLAY AREA
 - NATURAL LEARNING AREA
 - COMMUNITY CENTRE
 - BENCH
 - CONCRETE FILLED STEEL BOLLARDS
 - BIKE RACKS
 - ±1.2m HT. GRASS BERM
 - EXISTING WELL TO REMAIN
 - FLAGPOLE
 - SUBSURFACE FIELD DRAINAGE - REFER TO CIVIL DRAWINGS
 - DECORATIVE BOLLARDS
 - STOP ARRET SIGN (RA-1)
 - ENTRY PROHIBITED SIGN (RB-23)
 - PARKING LIMIT CONTROL SIGN (RB-53-L)
 - PARKING LIMIT CONTROL SIGN (RB-53-R)
 - NO PARKING FIRE LANE SIGN (RB-52A-L)
 - NO PARKING FIRE LANE SIGN (RB-52A-R)
 - COMPACTED GRANULAR PAVING - AREA TO BE PAVED WITH ASPHALT IN FUTURE PHASE
 - SILO AND OIL TANK AREA - REFER TO MECHANICAL DRAWINGS
 - 2.4m HEIGHT CHAIN LINK FENCE AND MAINTENANCE GATE
 - CIP CONCRETE PAD C/W ELECTRICAL CONDUIT FOR LIGHTING FOR FUTURE CUPOLA SCULPTURE - BY OTHERS

- LEGEND:**
- ASPHALT PAVING
 - CONCRETE PAVING
 - PRECAST CONCRETE UNIT PAVING
 - ENGINEERED WOOD FIBRE SAFETY SURFACING
 - TOPSOIL AND SEED
 - TOPSOIL AND SOD
 - PLANT BED
 - COMPACTED GRANULAR PAVING - AREA TO BE PAVED IN FUTURE PHASE
 - PROPERTY LINE
 - NEW CURB
 - 1.2m HT CHAIN LINK FENCE
 - 1.2m HT DECORATIVE FENCE
 - ACCESSIBLE PARKING STALL
 - NEW DECIDUOUS TREE
 - NEW CONIFEROUS TREE
 - PICNIC TABLE
 - BENCH

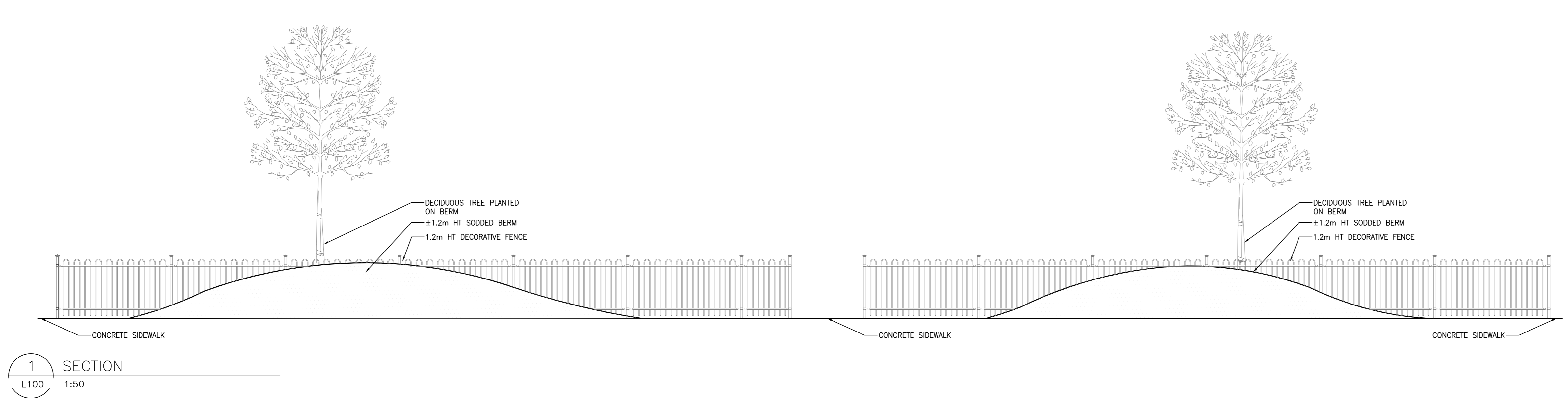

TRAFFIC SIGN SCHEDULE

SIGN	NAME	QUANTITY
RA-1 (60cmx60cm)	STOP ARRET	4
RB-23 (60cmx60cm)	ENTRY PROHIBITED	2
RB-53-L (30cmx45cm)	PARKING LIMIT CONTROL	1
RB-53-R (30cmx45cm)	PARKING LIMIT CONTROL	1
RB-53B (30cmx45cm)	ACCESSIBLE PARKING	3
RB-52A-L (30cmx45cm)	NO PARKING FIRE LANE	1
RB-52A-R (30cmx45cm)	NO PARKING FIRE LANE	1

ALL SIGN REFERENCE NUMBERS ARE TAC MANUAL OF UNIFORM TRAFFIC CONTROL DEVICES FOR CANADA. ACCESSIBLE PARKING AND NO PARKING FIRE LANE SIGN NUMBERS REFER TO THE PROVINCE OF NOVA SCOTIA SCHEDULE OF OFFICIAL TRAFFIC SIGNS.

ISSUED FOR CONSTRUCTION DISCLAIMER
"Issued for Construction" drawings and Specifications are for the convenience of the Contractor only and do not form part of the Contract Documents. The Contract Documents consist of the Contract, the "Issued for Tender" drawings and Specifications and any Addenda issued.

DATE	MARK	ISSUE
AUG 10/23	1	ISSUED FOR CONSTRUCTION
DEC 7/22	0	ISSUED FOR TENDER
		ISSUE

ISSUE: REVISION SCHEDULE

DISCLAIMER:
THIS DRAWING AND DESIGN IS COPYRIGHT PROTECTED WHICH SHALL NOT BE USED, REPRODUCED OR REVISED WITHOUT WRITTEN PERMISSION BY ARCHITECTURE 49 INC. THE CONTRACTOR SHALL CHECK AND VERIFY ALL DIMENSIONS AND REPORT ALL ERRORS AND OMISSIONS PRIOR TO COMMENCING WORK. THIS DRAWING IS NOT TO BE SCALED.
STAMP:

PROJECT:
PP-6 CONSEIL SCOLAIRE ACADIEEN CLARE TP3-MAIN BUILDING
LOWER SAULNIERVILLE, NOVA SCOTIA
SCALE: 1:300
DRAWN BY: NM
CHECKED BY: NM
REVIEWED BY: GML
APPROVED BY:
AS-BUILT CHECK:
DATE: DECEMBER 7, 2022

PROJECT NO.: L03-04-01-01
SHEET TITLE: LANDSCAPE - MATERIALS AND LAYOUT PLAN
INTERNAL NO.: 209-00111-00
DWG NO.: L-100
SHEET OF

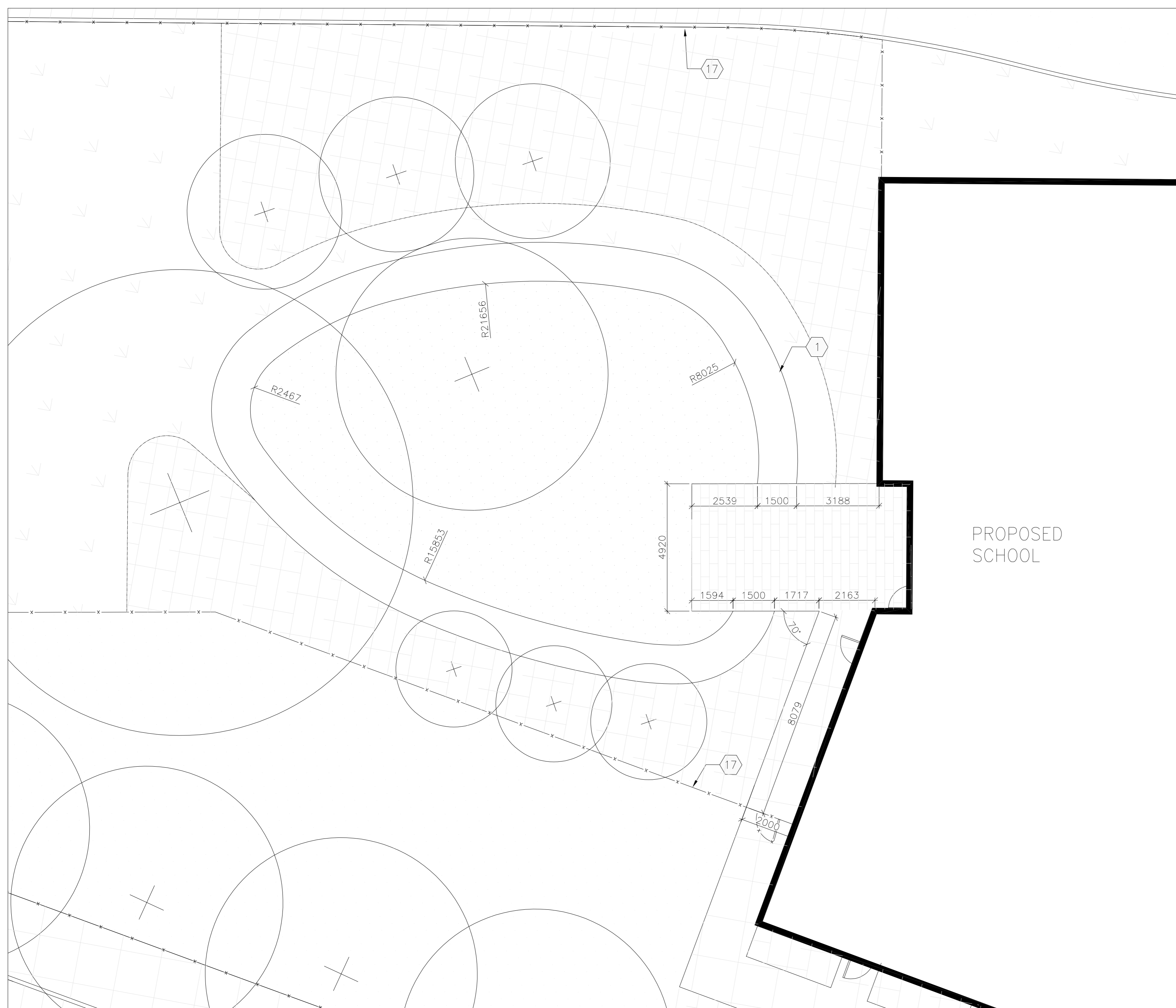

1 ENLARGEMENT 1
L101 1:100

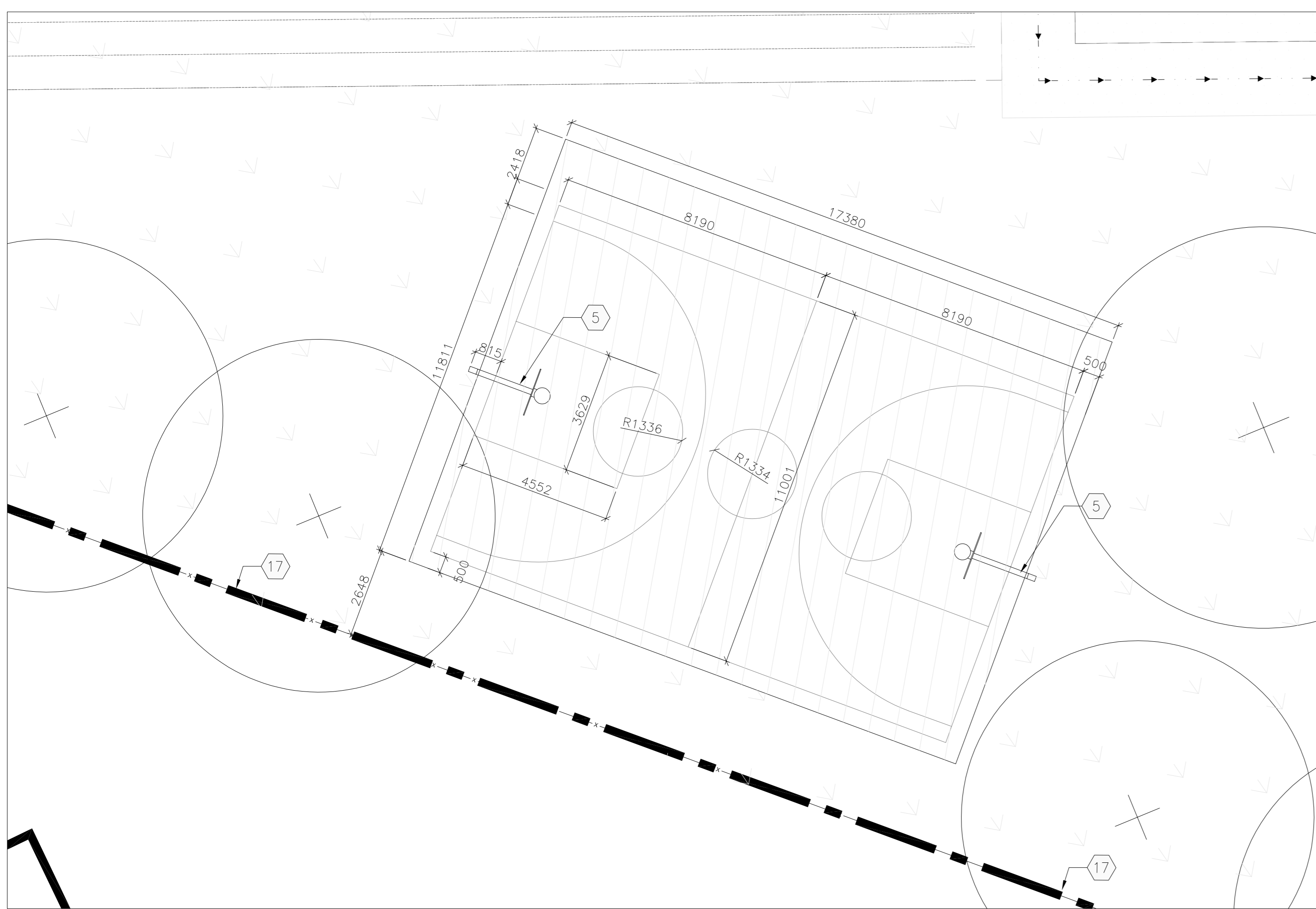

2 ENLARGEMENT 2
L101 1:100

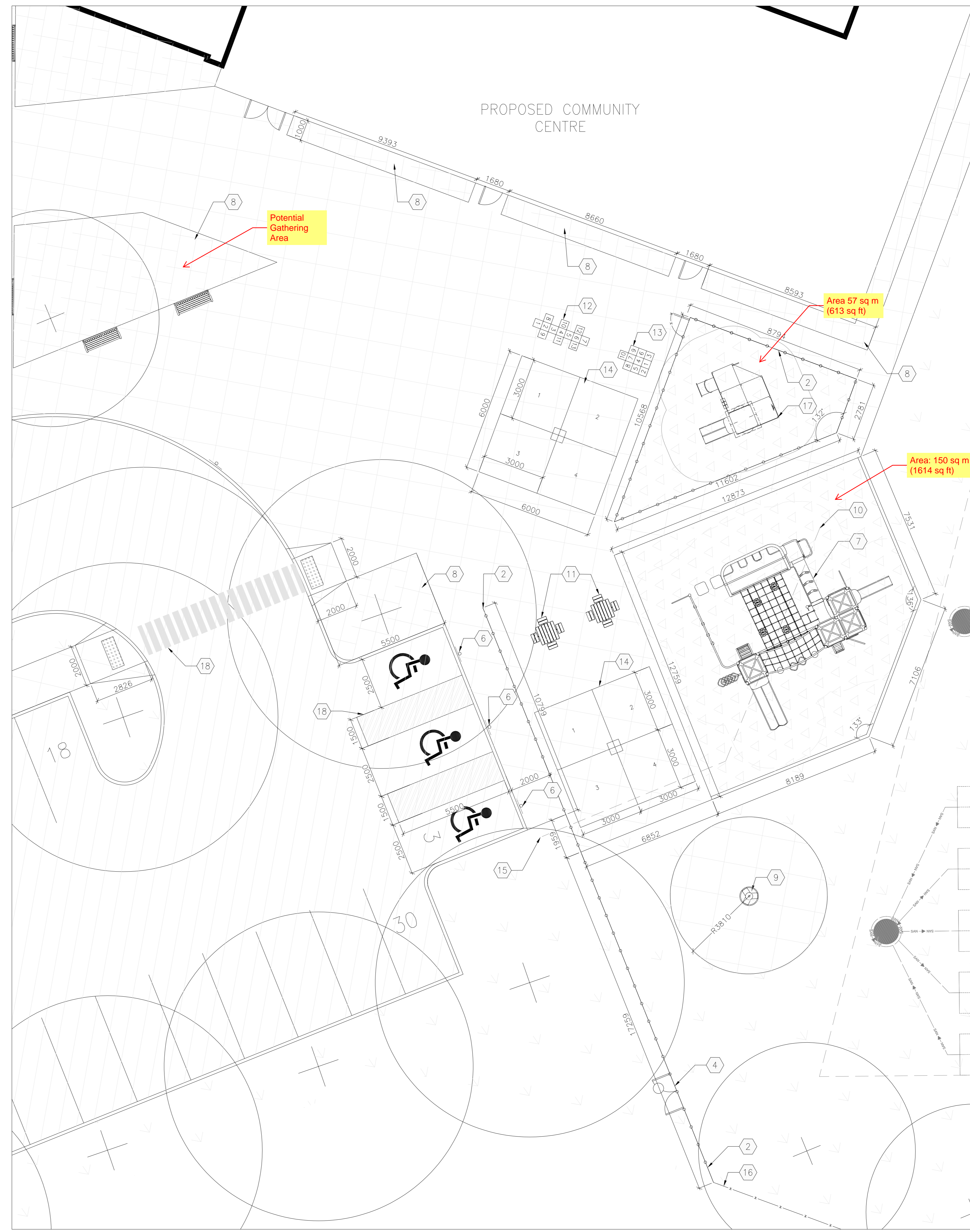

3 ENLARGEMENT 3
L101 1:100

KEYNOTES:

1. GRANULAR PATHWAY
2. 1.2m HT DECORATIVE FENCE
3. NATURAL LEARNING AREA
4. ENTRANCE GATE
5. BASKETBALL POLE
6. ACCESSIBLE PARKING SIGN (RB-52B)
7. AGES 5-12 PLAY STRUCTURE
8. PLANT BED
9. DROP SHOT BASKETBALL HOOP
10. PLAY SURFACE SUBSURFACE DRAINAGE LINE
11. PICNIC TABLES
12. HOPSCOTCH-PAINTED ON PAVEMENT
13. NUMBER GRID-PAINTED ON PAVEMENT
14. FOUR SQUARE-PAINTED ON PAVEMENT
15. SUBSURFACE DRAIN LINE TO CONNECT TO CB
16. 1.2m HT CHAIN-LINK FENCE
17. AGES 2-5 PLAY STRUCTURE
18. PAINTED PAVEMENT MARKINGS

LEGEND:

- ASPHALT PAVING
- CONCRETE PAVING
- ENGINEERED WOOD FIBRE SAFETY SURFACING
- TOPSOIL AND SEED
- TOPSOIL AND SOD
- PLANT BED
- PROPERTY LINE
- NEW CURB
- 1.2m HT CHAIN LINK FENCE
- 1.2m HT DECORATIVE FENCE
- ACCESSIBLE PARKING STALL
- NEW DECIDUOUS TREE
- NEW CONIFEROUS TREE
- PICNIC TABLE
- BENCH



KEY PLAN:
ARCHITECT:

ARCHITECTURE 49
1640 Market Street, Halifax, Nova Scotia, Canada, B3J 2C8
T: 902.429.5490 F: 902.429.2632 www.architecture49.com

ISSUED FOR CONSTRUCTION DISCLAIMER
"Issued for Construction" drawings and Specifications are for the convenience of the Contractor only and do not form part of the Contract Documents. The Contract Documents consist of the Contract, the "Issued for Tender" drawings and Specifications and any Addenda issued.

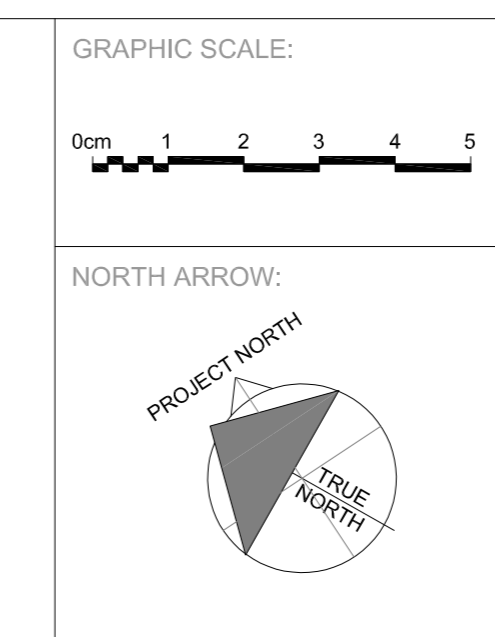

DATE	MARK	ISSUE
AUG 10/23	1	ISSUED FOR CONSTRUCTION
DEC 7/22	0	ISSUED FOR TENDER
		ISSUE

DISCLAIMER:
THIS DRAWING AND DESIGN IS COPYRIGHT PROTECTED WHICH SHALL NOT BE REPRODUCED OR REVISED WITHOUT WRITTEN PERMISSION BY ARCHITECTURE 49 INC. THE CONTRACTOR SHALL CHECK AND VERIFY ALL DIMENSIONS AND REPORT ALL ERRORS AND OMISSIONS PRIOR TO COMMENCING WORK. THIS DRAWING IS NOT TO BE SCALED.

STAMP:

PROJECT:
PP-6 CONSEIL SCOLAIRE ACADIEN CLARE TP3-MAIN BUILDING

LOWER SAULNIERVILLE, NOVA SCOTIA
SCALE: AS NOTED
DRAWN BY: NM
CHECKED BY: NM
REVIEWED BY: GML
AS-BUILT CHECK:
DATE: DECEMBER 7, 2022

PROJECT NO.: L03-04-01-01
SHEET TITLE: ENLARGEMENT PLANS
INTERNAL NO.: 209-00111-00
DWG NO.: L-101
SHEET OF



